

ZN-T5/W

Body Temperature Detection Network Camera



- On-board temp-detection algorithm
- One IP address two channels
- Effective pixels 400×300
- Sensitivity $\leq 40\text{mK}$
- Thermal: 8mm Fixed lens, Visible: 2.7~12mm motorized lens
- Accuracy $\pm 0.3^{\circ}\text{C}$
- Body temperature measurement up to 30 Targets
- Response Time $\leq 30\text{ms}$
- 17 color control

Specification

Thermal Camera		Visible Lens	
Detector Type	Uncooled IRFPA Microbolometer	Image Sensor	1/2.8" Sony CMOS
Effective Pixels	400(H) * 300(V)	Effective Resolution	1920(H) * 1080(V)
Pixel Size	17um	Shutter Speed	1/50 ~ 1/20,000s
Thermal Sensitivity (NETD)	$\leq 40\text{mK}$ @F1.0, 300K	Wide Dynamic Range	True WDR 120dB
Spectral Range	8 ~ 14um	Min. Illumination	Color: 0.1Lux @(F1.2, AGC ON) B/W: 0.01Lux @(F1.2, AGC ON)
Image Setting	Polarity LUT / DVE / Mirror / FCC / 3D DNR Brightness / Contrast / ROI	S / N Ratio	More than 55dB
Color Mode	Black-Heat / White-Heat / Rainbow / Iron-Red up to 17 modes	Focal Length	2.7 ~ 12mm
Thermal Lens		Max Aperture	F1.6 ~ F2.9
Lens Type	Fixed	FOV	105° ~ 32°
Focus Control	Manual Focus	Focus Control	Motorized
Focal Length	8mm		
Iris	F1.0		
FOV	H: 46°, V: 35°		

Video and Audio		Network	
Compression	H.265, H.264, MJPEG	Ethernet	RJ-45 (10 / 100Base-T)
Frame Rate	Main Stream: Thermal: D1 @25 / 30fps Visible: 1920 * 1080 / 1280 * 720 @25 / 30fps Sub Stream: Thermal: CIF @25 / 30fps Visible: D1 / VGA / 640 * 360 / CIF / QCIF / QVGA @25 / 30fps	Protocols	IPv4 / IPv6, HTTP, RTSP / RTP / RTCP, TCP / UDP, DHCP, DNS, PPPOE, SMTP, SIP, 802.1x
Bit Rate Control	CBR / VBR	Interoperability	ONVIF, CGI, SDK
Bit Rate	Thermal: 100Kbps ~ 6Mbps Visible: Main stream: 100Kbps~12Mbps Sub stream: 10Kbps ~ 1.5Mbps	Streaming Method	Unicast
Region of Interest	Off / On (8 Zone, Rectangle)	Max. User Access	10 Users
Digital Zoom	16x	Edge Storage	NAS Local PC for instant recording Micro SD card 128GB
Mirror	Support	Web Viewer	<IE11, Chrome, Firefox
Defog	Support	Web Language	English, Chinese, Polish, Italian, Portuguese, Spanish. Russian, French, Czech, Hungarian
Motion Detection	Support	Interface	
Privacy Masking	Off / On (4 areas, rectangle)	Ethernet	1 Ethernet (10 / 100 Base-T) RJ-45 Connector
DVE Image Enhance	Support	Audio	1ch Audio In, 1ch Audio Out
Audio Compression	G.711, RAW_PCM	Alarm	2ch Alarm In, 2ch Alarm Out
Intelligence		RS485	Support
Alarm	Motion detection, Disk alarm, I/O alarm, Temperature alarm	BNC Output	N / A
IVS	Smart Body Detection, Perimeter, Single Virtual Fences, Double Virtual Fences, Object Left, Object Removed	Reset Button	Support (Built-in)
Temperature Detection		General	
Detection Mode	Body temperature monitoring	Power Supply	DC12V / POE (IEEE 802.3af)
Detection Preset	Max 30 goals	Power Consumption	Max 10W
Temperature Alarm	Over temperature alarm, temperature difference alarm	Operating Temperature	-30°C ~ 60°C (-22°F ~ 140°F)
Accuracy	≤0.3°C (Emission rate, distance, ambient temperature) with blackbody	Storage Conditions	0 ~ 90% RH
Response Time	≤30ms	Certifications	CE / FCC
Detection Range	-20°C ~ 60°C (-4°F ~ 140°F)	Ingress Protection	IP66
Temperature display mode	If temperature target >5°C, display absolute temperature value; If temperature target ≤5°C, display relative temperature value (temperature difference DEV = highest value - average)	Casing	Metal
		Dimensions	212 * 182 * 136 (mm)
		Net Weight	2.1kg

Dimensions (mm)

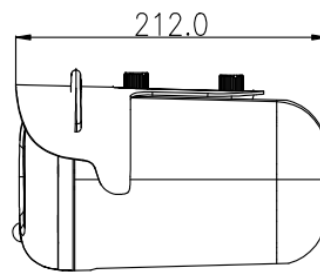
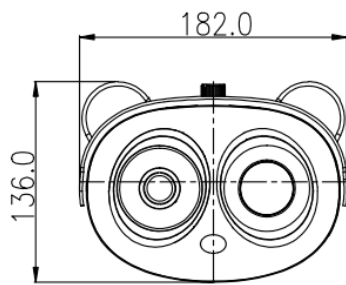

Accessories

Optional:

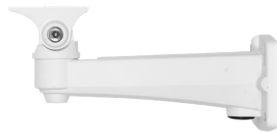

ZN - BK01
Wall bracket



ZN - BK02
Ceiling Bracket

ZN-TH01

Portable Blackbody



Specifications

General	
Temperature Range	40.0°C (Ambient temp. +5.0°C to 50.0°C)
Emissive Area	70mm × 70mm
Temperature Resolution	0.1°C
Accuracy	±0.2°C (@40°C)
Stability	±(0.1 ~ 0.2)°C / 30min
Emissivity	0.97 ± 0.02
Power Supply/Consumption	AC220V / 50Hz, 50W
Working Temperature/Humidity	0°C ~ 40°C / ≤80%RH
Dimensions (W * H * D)	110 × 120 × 180 (mm)
Weight	1.8kg
Optional	RS485